



## English Cottage Tea Cosy

Inspired by those lovely vintage patterns, and brought right up-to-date with freestyle machine embroidery, this little tea cosy is sure to please.

Mine is shown on a 2-cup pot, but I've included instructions for measuring your teapot so that your cosy will fit snugly over your own choice of pot.

S



Finished tea cosy measures 9" across base x 9" high. It's easy to change the dimensions - if you do so, then don't forget to re-size your applique pieces so they remain in proportion with the finished cosy.

If you are making for a different sized pot, then please follow the directions below to determine the size of your cosy...

- First measure your teapot's circumference by wrapping a tape measure around the entire pot, handle and spout included. Divide this figure in half to determine the width of each flat piece, and then add on 1½" for seam allowances and ease.
- If, for example, your teapot's circumference is 20", divide by two to get 10" and then add on 1½" for seam allowances. In this case the width of the base of your tea cosy pieces would be 11½"
- Next measure over the top of your teapot. Start at the table on one side, pull your tape measure up and over the lid and down to the table on the other side.
- Again divide your result by two, but this time add 3" (your pot will need room to breathe!)
- For example, if your measurement over the top of your teapot is 16", divide by two to get 8" and then add on 3" to make 11" So the height of your

cosy will be 11". Use these measurements to create the template for your cottage tea cosy - in this example it will measure 11 ½" wide x 11" tall to the top of the roof.

*All material requirements and instructions from now on are to make a 9" cosy like mine.*

#### **You will need:**

- Two 12" squares of pink medium-weight fabric for the exterior
- 2" x 3" rectangle fabric for chimney
- Two 12" squares of light green medium or quilting weight fabric for the lining
- Two 12" squares of lightweight batting or I used some old woollen blanket pieces that had been well washed and shrunk already
- Two 12" x 4" rectangles of thatch-coloured fabric for the roof
- 6" square light blue felt for shutters
- 4" square light coloured floral fabric for window panes
- 3" x 2" floral fabric for door
- 3" x 2" beige felt for pots
- Scraps of floral fabric for door panels and clothes on line
- 3 ½" x ½" tweedy fabric for clothes pole#
- Stranded cotton floss in two shades of green (light & dark) and assorted colours of your choice for the flowers. I used 309, 677, 701, 704, 827, 3716, 3726 but it's really up to your personal choice.
- Dark green, black and cream thread for machine needle, light colour in bobbin
- Embroidery foot for sewing machine
- Temporary fabric marker pen
- Bondaweb

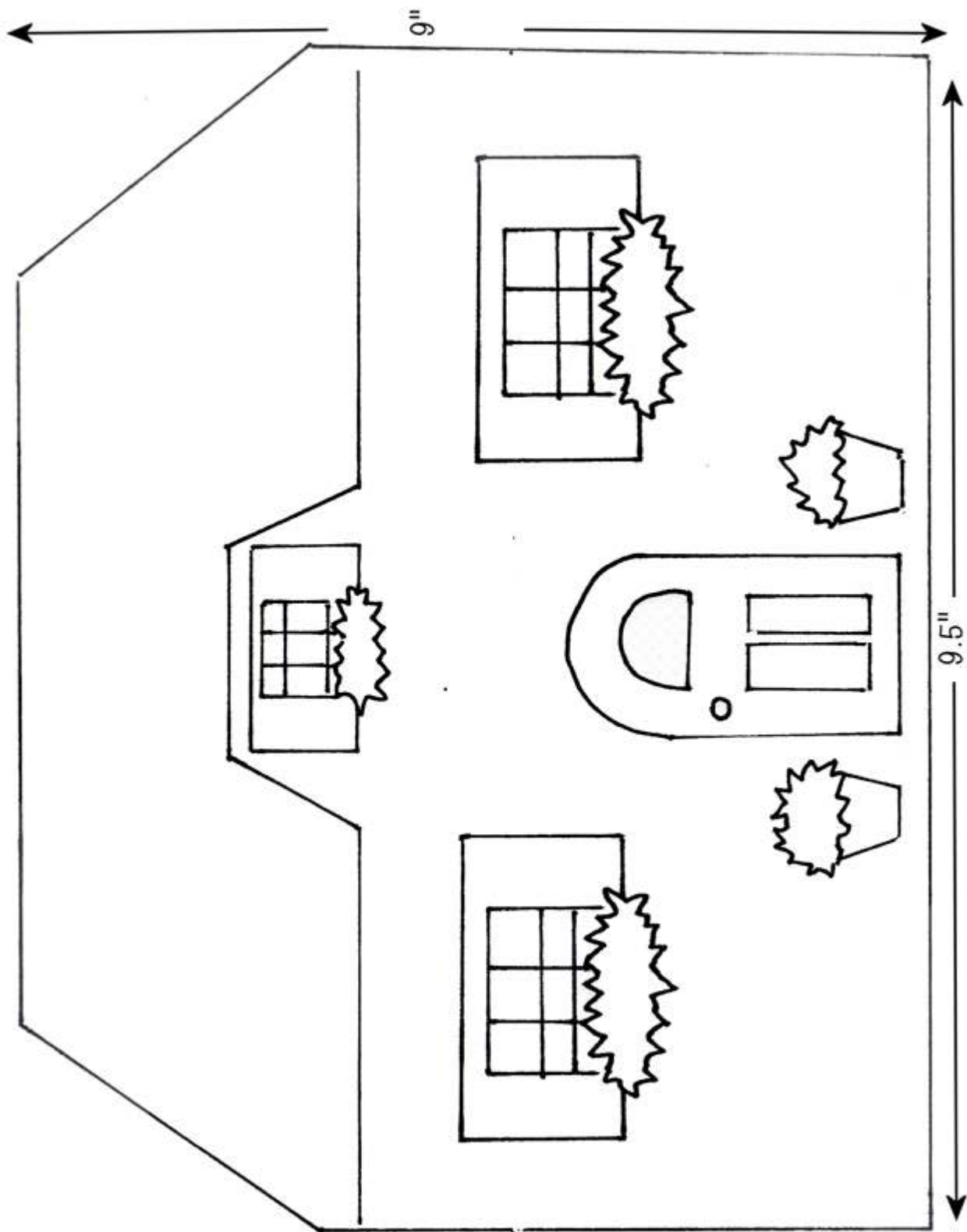

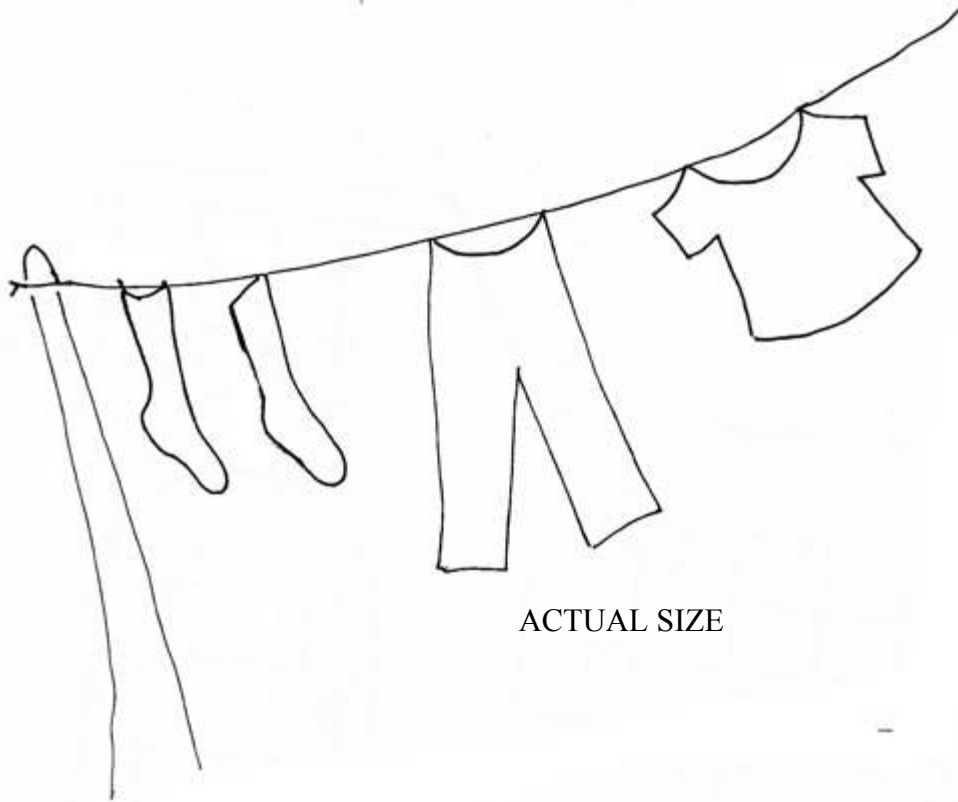

### Method:

- The template for the washing is given actual size, but you will need to resize the front template - that should be quite easy as it's such a simple geometric shape. The full size dimensions are shown on the template.
- Place your template on the 2 rectangles external fabric and draw around it using your temporary marker pen. Do not cut it out yet - the extra fabric is useful when you are using an embroidery hoop to stitch the flowers.

### Front:

- Trace the door, flowerpot, shutters and window shapes onto the paper side of your Bondaweb, and fuse to the felt and fabric you've chosen for your applique.
- Position on the front fabric and fuse with your iron (use a cloth to protect the felt if necessary).

- With your temporary marker pen draw in the window panes and the outline of the window boxes
- With your embroidery foot, feed dogs dropped and black or dark coloured thread in your needle, stitch around the door and shutters going around twice and aiming for a sort of scribbled effect. Stitch the window panes in the same way.
- Now work the window boxes and flower pots using two strands of cotton floss. Start with the leaves - have some sticking out around the edges and then scatter through the main body of your embroidery. Fill in with French knots, mixing the different colours for a cottagey sort of effect.
- Stitch the door knob in pale yellow satin stitch.
- Press work on reverse and set to one side.



- Fold your chimney fabric in half length ways, right sides together and machine stitch down long edge with a ¼” seam allowance.
- Turn the right way out and press with the seam at the back.
- Position chimney at centre top of front panel, aligning the edge with the top edge of the roof. Pin in place

### Back:

- Work the window at the back in exactly the same way as those on the front of the cosy.
- Cut out applique shapes for clothing and clothes pole in the same way. The bottom of the clothes pole should be about 4 ½” along from the left hand seam (approx).
- Machine stitch clothing and pole as before. Add some hand-stitched grass in back stitch.
- Draw in clothes line in your temporary fabric marker pen, then machine stitch in black thread.
- Press your work lightly on the reverse.



- Place the front and back right sides together and machine all around the side and top edges with a ¼” seam allowance.

### Assemble exterior:

- Cut your front and back to shape around the lines you traced earlier (ie removing the excess fabric you left in place to make using a hoop easier)
- Cut your two roof pieces from your thatch-coloured fabric using the template and omitting the scoop around the top window for the back of the cosy. My fabric had a nice selvedge so I used that as the edge of the thatch - you could fray the edge if yours doesn't have this.
- Position thatch on tea cosy front and back. With cream thread in your needle machine stitch along bottom edge of thatch ¼” from the edge. Then zig-zag or machine around the exterior edges to hold the thatch in place while you assemble your cosy.

### Interior:

- Cut out interior using template shape, but add 1” to the bottom edge.
- Cut out wadding or blanket fabric.
- Baste wadding to wrong side of lining fabric



- Draw flower shapes on interior of cosy using your temporary fabric marker pen - these are so simple - just like the ones you used to doodle as a child. (you can omit this step if you prefer, quilt conventionally, or use a pre-quilted fabric)



- With your embroidery foot and dark green thread quilt over the flower shapes you draw. It's fun to squiggle over the flower centres (see picture above)
- Remove the temporary lines.



- Place your two interior pieces right sides together and machine around edges with a  $\frac{1}{4}$ " seam allowance, leaving a 3" gap for turning.

### Assemble your cosy:

- Place your exterior inside your interior with right sides together and aligning bottom edge.
- Pin or tack together around bottom edge, making sure you align the side seams at the bottom.
- Stitch around the bottom edge.
- Turn cosy the right way round through the 3" gap you left in the lining and topstitch the gap closed.
- Push the lining up inside the cosy. Because it's slightly longer you will have between  $\frac{1}{2}$ " and  $\frac{3}{4}$ " remaining on the outside. That will form a nice grass-coloured edging.
- Press well along side seams and along the bottom.
- With cream thread stitch in the ditch all the way around the bottom of the cosy where the pink exterior fabric joins the green lining. This will make a nice neat finish and keep everything in place.
- FINISHED!!





Why do we love to stitch? After all, you can purchase mass-produced embroidered items at many high street stores. These days, handmade means something special – a unique item created with love, a gift from the heart, not one that can be bought. Hand stitching is also a great way to personalize an item, or even to breathe new life into an old favourite that has seen better days.



[Bustle & Sew](#) offers my own unique patterns, designed to appeal to all skill levels and bring out your natural creativity. And you can keep up-to-date with all the latest news on the [Bustle & Sew Blog](#).

But none of this would mean anything without you, the stitcher.

So I'd like to say "thank you" for purchasing this pattern. Please respect my copyright and do not copy and/or circulate it for any purpose whatsoever. You may sell items you personally make using it, provided you credit Bustle & Sew with the design but you are not licensed to go into mass production.

Best wishes

Helen xx



Your first issue includes your free gift "The Stitcher's Companion"

PS : If you love stitching then you're sure to enjoy my Bustle & Sew e-zine. It's my own e-zine delivered monthly to your in-box stuffed with ideas, projects, features, articles, patterns and more. Your family and friends will be queuing up to take delivery of your new Bustle & Sew creations.

To learn more, please visit my website.

<http://bustleandsew.com/magazine>